

# KLEMMFILZ

Product data sheet



**ecomat**.be  
info@

**Item number**  
**Density**  
**Raw material**  
**Application**

KF-03000BR24  
30 kg/m<sup>3</sup>  
100% wool sustainable, durable, recyclable, without synthetic additives  
Interior finishing, room air renovation – Partition walls, installation level, Suspended (acoustic-)ceiling



## PRODUCT DESCRIPTION

- The clamping felt roll is the **high-performance insulation** with an exceptional thermal and sound insulation effect.
- Improved **sound-absorbing effect** in partition walls.
- For clamping between supporting structures, fasten mechanically.



## WOOL PROTECTION

- **IONIC PROTECT®** biocide-free wool protection, long-term tested by EAD/CUAP standards and patented procedure.
- Is a slight alteration of the molecular protein structure of the wool fibre through a **plasma-ion treatment**. This specific process is unique as it permanently prevents the wool from being a nutritional source for wool parasites.
- Through the wool protection, our products have an **unlimited shelf-life**.



## INSTALLATION

- **Quick installation**, no waste and dust collect. Ideally suited for working overhead.
- Insert the insulation rolls from bottom to top and fix the surface felt to the rafters by stapling it laterally.
- The rolls can be cut to length by **tearing by hand** or with the **ISOLENA** cutting device.

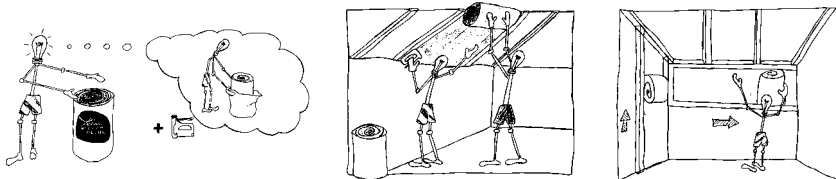

## PROPERTIES



Sheep wool insulation



Air purification



Humidity regulation



Sound insulation  
Fire protection



Sustainable



Wool protection



## FORM OF DELIVERY

### DIMENSIONS\*

**Width:** 250 – 2.300 mm in 25 mm increments (250, 275, 300, 325, 350 mm,...)

**Thickness:** 20 – 80 mm in 10 mm increments (20, 30, 40, 50 mm,...)

| Article | kg/m <sup>3</sup> | Thickness (mm) | Width (mm) | Lengths (mm) | Item/PU | m <sup>2</sup> /PU | PU/Pal | m <sup>2</sup> /Pal |
|---------|-------------------|----------------|------------|--------------|---------|--------------------|--------|---------------------|
| KF30    | 30                | 30             | 600        | 9.000        | 2       | 10,80              | 18     | 194,40              |
| KF30    | 30                | 40             | 600        | 6.000        | 2       | 7,20               | 18     | 129,60              |
| KF30    | 30                | 50             | 600        | 6.000        | 2       | 7,20               | 14     | 100,80              |
| KF30    | 30                | 50             | 625        | 6.000        | 2       | 7,50               | 14     | 105,00              |
| KF30    | 30                | 60             | 600        | 6.000        | 2       | 7,20               | 12     | 86,40               |
| KF30    | 30                | 80             | 600        | 4.000        | 2       | 4,80               | 14     | 67,20               |

\*Special sizes available from a minimum production quantity of one pallet approx. 4,85 m<sup>3</sup> at no extra charge.



## TECHNICAL DATA

|  |                               |      |      |      |       |       |       |
|--|-------------------------------|------|------|------|-------|-------|-------|
| European technical approval  | ETA-07/0214                   |      |      |      |       |       |       |
| Nature Plus®   | 0103-1006-099-1               |      |      |      |       |       |       |
| Thermal conductivity λ <sub>tr</sub>   | 0,033 W/mK                    |      |      |      |       |       |       |
| Vapour diffusion resistance factor μ   | 1                             |      |      |      |       |       |       |
| Specific heat capacity c   | 1760 J/kgK                    |      |      |      |       |       |       |
| Length-related flow resistance according to EN 29053                         | r = 10,2 kPa s/m <sup>2</sup> |      |      |      |       |       |       |
| Fire behaviour according to EN 13501-1                                       | D-s2, d0; CH: RF3             |      |      |      |       |       |       |
| Degree of sound absorption with a thickness of 50 mm according to ISO 354    | f [Hz]                        | 125  | 250  | 500  | 1.000 | 2.000 | 4.000 |
|  | α <sub>s</sub>                | 0,44 | 0,60 | 0,78 | 0,98  | 1,08  | 1,14  |
| Assessed degree of sound absorption D. 50 mm according to ÖNORM EN ISO 11654 | α <sub>w</sub> = 0,85         |      |      |      |       |       |       |
| Mould growth intensity according to EN ISO 846                               | 0                             |      |      |      |       |       |       |



## ECOLOGICAL PARAMETERS

Compliant with the NaturePlus® Life cycle assessment **IOLENA**

|  |          |   |
|--|----------|---|
| Use of non-renewable <b>primary energy</b> without the non-renewable primary energy carriers used as raw material ( <b>PENRE [MJ, lower calorific value]</b> ) | 23,44    | MJ/kg                                       |
| <b>Global warming potential</b> Total of GHG emissions and CO <sub>2</sub> storage ( <b>GWP 100 total</b> )  | 0,83     | kg CO <sub>2</sub> -äquiv./kg               |
| <b>Acidification</b> potential of soil and water (AP)  | 4,63E-03 | kg SO <sub>2</sub> -äquiv./kg               |
| <b>Potential</b> for the formation of tropospheric ozone ( <b>POCP</b> )   | 8,04E-04 | kg C <sub>2</sub> H <sub>4</sub> -äquiv./kg |
| <b>Eutrophication potential (EP)</b>   | 2,08E-03 | kg PO <sub>4</sub> <sup>3-</sup> -äquiv./kg |

