

PREMIUM

Product data sheet

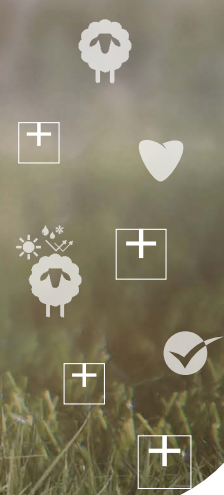

ecomat.be
info@

Item number
Density
Raw material
Application

PRE02000BR24
20 kg/m³
100% wool sustainable, durable, recyclable, without synthetic additives
Roof extension, Ceiling – overhead insulation, storey ceiling, tie-beam roof, Interior & exterior wall, Wooden construction



PRODUCT DESCRIPTION

- The compact thermal and sound insulation in high insulation thicknesses from 120 to 300 mm in one (single layer!) insulation roll. The thickness is elastic and also encloses cable ducts without further processing.
- Small excesses in width flexibly adapt to the construction.
- The insulation roll for the installation in **horizontal** and **inclined supporting structures** (rafters, frames, transoms, etc.).

WOOL PROTECTION

- **IONIC PROTECT®** biocide-free wool protection, long-term tested by EAD/CUAP standards and patented procedure.
- Is a slight alteration of the molecular protein structure of the wool fibre through a **plasma-ion treatment**. This specific process is unique as it permanently prevents the wool from being a nutritional source for wool parasites.

INSTALLATION

- **Quick installation**, no waste and dust collect. Ideally suited for working overhead.
- Insert the insulation rolls from bottom to top and fix the surface felt to the rafters by stapling it laterally.
- The rolls can be cut to length by **tearing by hand** or with the **ISOLENA** cutting device.

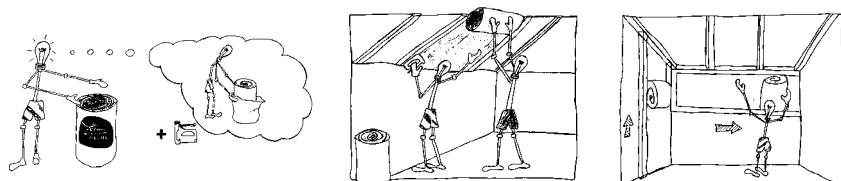

PROPERTIES

 Sheep wool insulation	 Air purification	 Humidity regulation	 Sound insulation Fire protection	 Sustainable	 Wool protection
--	---	--	--	---	--

PREMIUM

Product data sheet



IOLENA NEWSLETTER
 Receive relevant news every
 three weeks:
<https://bit.ly/3iKhtKg>

Subscribe now!



FORM OF DELIVERY

DIMENSIONS*

Width: 250 – 1.600 mm in 50 mm increments (250, 300, 350, 400 mm,...)

Thickness: 120 – 300 mm in 10 mm increments (120, 130, 140, 150 mm,...)

Article	kg/m ³	Thickness (mm)	Width (mm)	Lengths (mm)	Item/PU	m ² /PU	PU/Pal	m ² /Pal
PRE20	20	120	600	4.000	2	4,80	14	67,20
PRE20	20	140	600	3.000	2	3,60	14	50,40
PRE20	20	160	600	3.000	2	3,60	14	50,40
PRE20	20	160	1.200	3.000	1	3,60	14	50,40
PRE20	20	180	600	2.500	2	3,00	14	42,00
PRE20	20	200	600	2.500	2	3,00	12	36,00

*Special sizes available from a minimum production quantity of one pallet approx. 7,20 m³ at no extra charge.



TECHNICAL DATA

European technical approval	ETA-07/0214						
Nature Plus®	0103-1006-099-1						
Thermal conductivity λ _{tr}	0,035 W/mK						
Vapour diffusion resistance factor μ	1						
Specific heat capacity c	1760 J/kgK						
Fire behaviour according to EN 13501-1	D-s2, d0; CH: RF3						
Degree of sound absorption with a thickness of 50 mm according to ISO 354	f [Hz]	125	250	500	1.000	2.000	4.000
	α _s	0,43	0,47	0,68	0,76	0,86	0,95
Mould growth intensity according to EN ISO 846	0						



ECOLOGICAL PARAMETERS

Compliant with the NaturePlus® Life cycle assessment **IOLENA**

Use of non-renewable primary energy without the non-renewable primary energy carriers used as raw material (PENRE [MJ, lower calorific value])	23,44	MJ/kg
Global warming potential Total of GHG emissions and CO ₂ storage (GWP 100 total)	0,83	kg CO ₂ -equiv./kg
Acidification potential of soil and water (AP)	4,63E-03	kg SO ₂ -equiv./kg
Potential for the formation of tropospheric ozone (POCP)	8,04E-04	kg C ₂ H ₄ -equiv./kg
Eutrophication potential (EP)	2,08E-03	kg PO ₄ ³⁻ -equiv./kg

